

FIRST FLOOR PLAN

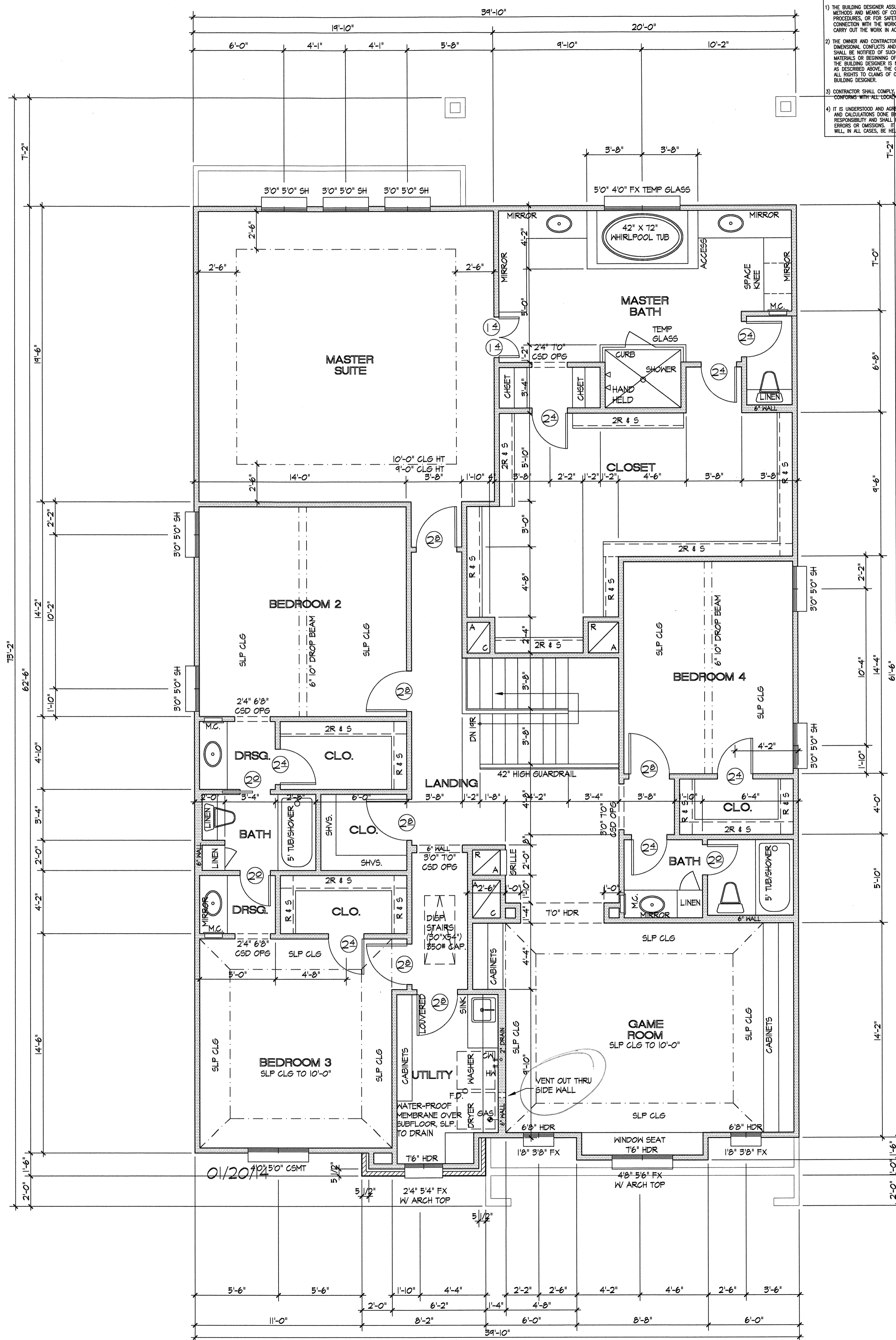

SECOND FLOOR PLAN

GENERAL NOTES:
 1) TO THE BEST OF THE DESIGNER'S KNOWLEDGE, THESE PLANS HAVE BEEN PRODUCED TO THE OWNER'S SPECIFICATIONS. EVERY ATTEMPT HAS BEEN MADE TO FOLLOW THE SPECIFICATIONS AND AVOID MISTAKES.
 2) THE BUILDING DESIGNER ASSUMES NO RESPONSIBILITY FOR THE METHODS AND MEANS OF CONSTRUCTION, TECHNIQUES, SEQUENCES, PROCEDURES, OR FOR SAFETY PRECAUTIONS AND PROGRAMS IN CONNECTION WITH THE WORK OR THE FAILURE OF SOMEONE TO CARRY OUT THE WORK IN ACCORDANCE WITH THE DRAWINGS.
 3) THE OWNER AND CONTRACTOR SHALL CHECK ALL DRAWINGS FOR DIMENSIONAL CONFLICTS AND OMISSIONS. THE BUILDING DESIGNER SHALL BE NOTIFIED OF SUCH PRIOR TO THE FABRICATION OF MATERIALS OR BEGINNING OF CONSTRUCTION OF THE BUILDING. IF THE BUILDING DESIGNER IS NOT NOTIFIED IN WRITING OF ERRORS AS DESCRIBED ABOVE, THE OWNER AND CONTRACTOR SHALL WAIVE ALL RIGHTS TO CLAIM OF OMISSION AND ERRORS BY THE BUILDING DESIGNER.
 4) CONTRACTOR SHALL CORRECT AND VERIFY THAT THE BUILDING CONFORMS WITH ALL APPLICABLE NATIONAL BUILDING CODES.
 5) IT IS UNDERSTOOD AND AGREED BY ALL PARTIES THAT ALL DRAWINGS AND CALCULATIONS DONE BY THE ENGINEER ARE HIS / HER RESPONSIBILITY AND SHALL BE THE SOLE BASIS FOR ANY ERRORS OR OMISSIONS. IT IS FURTHER AGREED THAT THIS DESIGNER WILL, IN ALL CASES, BE HELD HARMLESS.

CALCULATED AREAS	
FIRST FLOOR	2,019
SECOND FLOOR	2,427
TOTAL HEATED	4,446
GARAGE - COCHERE	508
PORCHES	260
T.C.A.	5,214

Tim Roesler's Designs & Concepts
 Design, Planning & Consultants
 (281) 217-6614

Signature
PROJECT :
 L.K. CUSTOM HOMES
 4903 CEDAR
 Date: 11/27/13
 File Name: 4903 CEDAR

Revisions

No.	Description

ELECTRICAL PLANS

SCALE 1/4" = 1'-0"